

South San Luis Obispo County Sanitation District

Wastewater Treatment Plant Redundancy Project



Pre-SOQ Meeting for
Construction Management Services

May 14, 2019



Outline

- Purpose
- Introductions
- Background
- Scope of Work
- Schedule
- Evaluation Criteria
- Questions



Background – Existing Facility

- Wastewater Treatment Plant
 - Designed and permitted for PDWF = 5 MGD, PWWF = 10 MGD
 - Current average day flow of 2 – 3 MGD
 - Treats wastewater from Arroyo Grande, City of Grover Beach, & Oceano
 - Mechanically-Cleaned Screen/Grit Removal
 - Primary Clarifiers
 - Fixed Film Reactor
 - Secondary Clarifier
 - Anaerobic Digestion
 - Dewatering Centrifuge
 - Chlorination/dechlorination
 - Ocean outfall
 - No current redundancy in secondary treatment



Redundancy Project – Primary Components

- Two activated sludge aeration basins
- One new secondary clarifier
- Fixed film reactor effluent and primary effluent pump station
- Waste activated sludge thickener with modifications to existing dewatering platform
- Blower, electrical, and motor control center (MCC) building
- Yard piping, fire water system, paving and grading improvements
- Ground improvements in areas of new construction
- Instrumentation and controls and electrical systems
- Floodproofing of critical plant systems
- Rehabilitation of existing secondary clarifier
- New generator to provide power for new facilities
- Valves, gates, and other work for complete system
- Majority of work on existing plant site



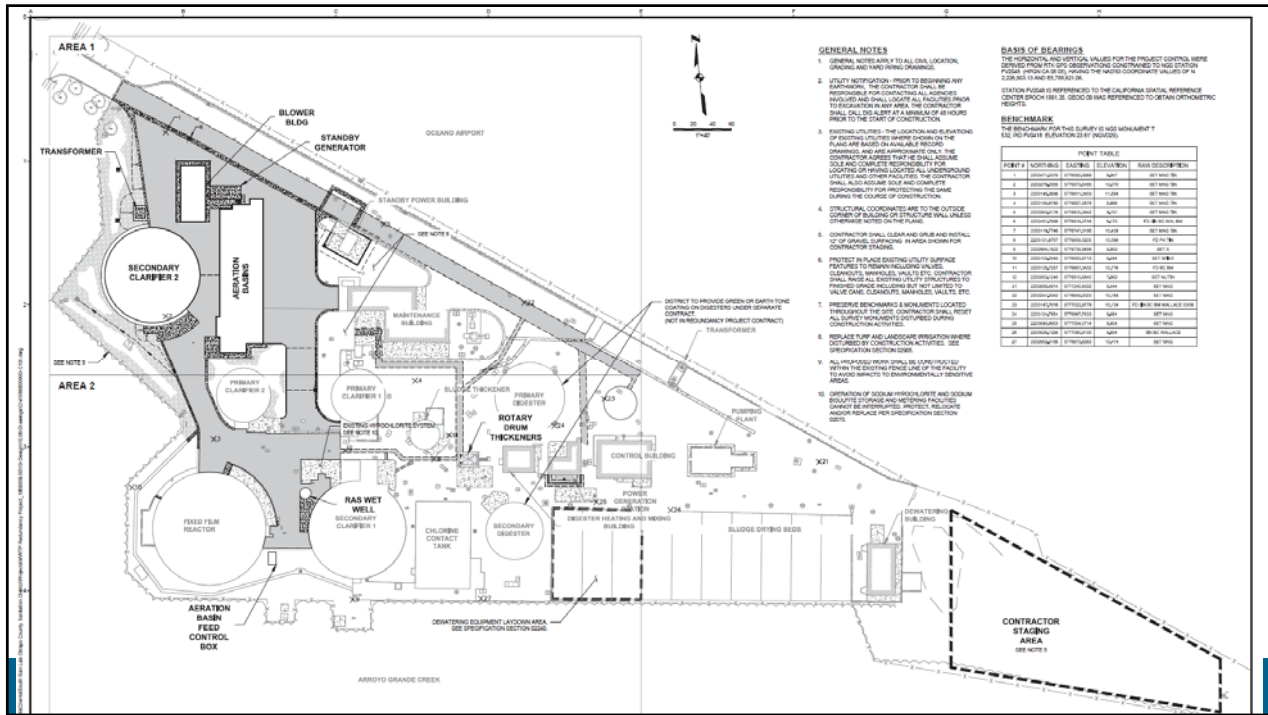

Redundancy Project

Additional Contractor Responsibilities

- Ensure WWTP maintains continuous operation and compliance with permit during construction
- Protect existing facilities and pipelines from settlement and damage and monitor movement
- Provide for abatement and testing of products with lead-containing paint per regulations

Owner-furnished and installed items

- Owner is paying PG&E for a new primary transformer and primary electrical service conductors. PG&E will install after inspection of Contractor-provided groundwork.



Project Status

- Final Coastal Development Permit received (May 6, 2019)
- Opinion of Probable Construction Cost \$21,300,000
- Financial Plan:
 - Rates already adopted, additional rate increase not required
 - Pursuing USDA loan, possible grant
 - Municipal Bonds
- Project Labor Agreement under development



Scope of Work

- Construction Administration
 - Construction Admin Procedures Manual
 - Pre-construction meeting
 - Document control
 - Monitor schedule and cost
 - Reporting
 - Web Based Centralized Document and Change Management System
- Field Observation
 - Day to day CM and observation
 - Special inspections
 - Weekly meetings
 - Project reporting
 - Coordinate special inspections
 - Coordinate tie-in's, startups
 - Close out activities
- Bid Phase
 - Develop risk registry
 - Attend pre-bid meeting
- Regulatory and Funding Compliance
 - Labor Compliance
 - Certified Payroll
 - Federal cross-cutters
 - Monitor compliance with CDP
 - Project reports (as required)



Anticipated Procurement Schedule

- RFQ Issued: May 9, 2019
- Pre-SOQ meeting: May 14, 2019
- Individual meeting/site visit: Before June 7 and not including week of May 27
- Written questions due: June 11, 2019 at 5 PM
- Responses to Questions posted by: June 19, 2019
- SOQs due: June 27, 2019 at 4:00 PM at District office (WWTP)
- Notification of consultant shortlist: July 8, 2019
- Interviews (at District's option): Week of July 15, 2019
- Selection of Top-ranked proposer & contract negotiation: July 22 – Aug 9, 2019
- Consultant selection & Board Approval: September 4, 2019
- Notice to Proceed: September 5, 2019
- Construction: Bid late summer, construct Dec 2019 – May 2022 (Tentative)



Evaluation Criteria

Criteria	Maximum Points
Quality and clarity of SOQ, and understanding of the work	20
Experience of Project Manager and key team members on similar projects (aeration basins, clarifiers, maintaining operations of existing facility, federal funding, etc.)	30
Firm's history of construction administration and construction management with management of construction change orders and schedule impacts	20
Proposed project approach, identification of key project challenges, approach to reduce overall risk, and collaboration with the District's Team	30
Total	100



Questions?

Follow-up questions can be directed to the District's Project Manager:
Eileen Shields – eshields@mknassociates.us

Thank You!